

OWNER:
1st ASSEMBLY OF GOD ATHENS
1225 COLLEGE STATION ROAD
ATHENS, GA 30605
(706) 548-3409

MINIMUM TREE CANOPY COVERAGE
PROPERTY ZONED:
C-O = 6.51 ACRES
REQUIRED TREE CANOPY COVERAGE = 50%
REQUIRED LANDSCAPED AREA = 325%
REQUIRED CONSERVED TREE CANOPY COVERAGE = 25%

C-N = 4.51 ACRES
REQUIRED TREE CANOPY COVERAGE = 45%
REQUIRED LANDSCAPED AREA = 20%
REQUIRED CONSERVED TREE CANOPY COVERAGE = 15%

TOTAL EXISTING CANOPY COVERAGE:
C-O REQUIRED PERCENTAGE OF CONSERVED TREE CANOPY COVERAGE =
= 283,576 (6.51 AC) X 0.50 = 141,788 SQ. FT.
= 85,771 SQ. FT. (1.97 AC) CONSERVED
= 85,771/283,576 = 30% CONSERVED

C-N REQUIRED PERCENTAGE OF CONSERVED TREE CANOPY COVERAGE =
= 196,350 (4.51 AC) X 0.45 = 88,371 SQ. FT.
= 15,682 SQ. (0.36 AC) CONSERVED
= 15,682/196,350 = 8% CONSERVED

TREE CANOPY COVERAGE REQUIREMENTS
C-O = 283,576 (6.51 AC) X 0.50 = 141,788 SQ. FT.
C-N = 196,350 (4.51 AC) X 0.45 = 88,371 SQ. FT.

WEIGHTED EXISTING CANOPY COVERAGE:
C-O = 196,350 SQ. FT.
C-N = 283,576 SQ. FT.
TOTAL SITE = 480,103.67 SQ. FT.

C-O = 196,350 / 480,103.67 = 0.41
REQUIRED CONSERVED TREE CANOPY COVERAGE = 15%
= 0.41 X 0.15 = 0.06

C-N = 283,576 / 480,103.67 = 0.59
REQUIRED CONSERVED TREE CANOPY COVERAGE = 25%
= 0.59 X 0.25 = 0.15

0.06 + 0.15 = 0.21
WEIGHTED = 21% CONSERVED TREE CANOPY COVERAGE REQUIRED FOR ENTIRE SITE

CONSERVED TREE CANOPY COVERAGE FOR ENTIRE SITE
C-O = 15,682 SQ. FT. (0.36 AC) CONSERVED
C-N = 85,771 SQ. FT. (1.97 AC) CONSERVED
= 15,682 + 85,771 = 101,453 SQ. FT. CONSERVED
= 101,453/480,104 = 21%

TREES PLANTED TO SATISFY CANOPY COVERAGE REQUIREMENT (SEE PLANT LIST):
C-O = 57,450 SQ. FT. (1.32 AC) + EX 85,771 SQ. FT. (1.97 AC) = 143,221 SQ. FT.
C-N = 75,200 SQ. FT. (1.73 AC) + EX 15,682 SQ. FT. (0.36 AC) = 90,882 SQ. FT.

ENGINEER:
GEORGIA CIVIL, INC.
216 N. MAIN STREET
MADISON, GA 30650
(706) 342-1104

BOUNDARY & TOPOGRAPHIC SURVEY
INFORMATION PROVIDED FROM FIELD RUN
SURVEY BY:
LANDMARK ENGINEERING CORPORATION
475 NEWTON BRIDGE ROAD
ATLANTA, GA 30667
(706) 548-6622

TREE QTY.	COMMON NAME	BOTANICAL NAME	HEIGHT	SIZE	ROOT CONDITION	REMARKS	CANOPY COVER (PER TREE)	TOTAL CANOPY COVER AREA
22	TRIDENT MAPLE	ACER RUBRUM VAR.	5'-6"	7" CAL.	BAR	FULL HEAD	400 SQ. FT.	8,800 SQ. FT.
5	CHINESE PISTACHE	PISTACHIA CHINENSIS	5'-6"	7" CAL.	BAR	FULL HEAD	500 SQ. FT.	2,500 SQ. FT.
4	LITTLE GEM MAGNOLIA	MAGNOLIA GRIFFITHII VAR. LITTLE GEM	5'-6"	7" CAL.	BAR	FULL TO GROUND	150 SQ. FT.	600 SQ. FT.
6	AMERICAN HOLLY	ILEX OPACA	5'-6"	7" CAL.	BAR	FULL TO GROUND	150 SQ. FT.	900 SQ. FT.
11	CHINESE ELM (LACE BARK)	ULMUS PARVIFLORA	5'-6"	7" CAL.	BAR	FULL HEAD	100 SQ. FT.	1,100 SQ. FT.
9	GOLDENRAINTREE (8)	KOELBUTERA PANICOLATA	5'-6"	7" CAL.	BAR	FULL HEAD	400 SQ. FT.	3,600 SQ. FT.
13	CHASTETREE	VITEX AGNUS-CASTUS	5'-6"	7" CAL.	BAR	FULL HEAD	150 SQ. FT.	1,950 SQ. FT.
31	WILLOW OAK	QUERCUS PHellos	5'-6"	7" CAL.	BAR	FULL HEAD	1,000 SQ. FT.	31,000 SQ. FT.
50	GINKGO (MALE)	GINKGO BILOBA	5'-6"	7" CAL.	BAR	FULL HEAD	1,000 SQ. FT.	50,000 SQ. FT.

STREET TREE FRONTAGE CALCS.

TOTAL ROAD FRONTAGE -
COLLEGE STATION RD. = 875.40 L.F.
INTERNATIONAL DRIVE = 864.05 L.F.

REQUIRED FRONTAGE TREES = 1 PER 30 L.F.
INTERNATIONAL DRIVE = 28 TREES
COLLEGE STATION RD. = 29 TREES (APPROX. 1 PER 25 L.F.)
INTERNATIONAL DRIVE = 0 TREES PROPOSED + 19 EX. TREES ALONG INTERNATIONAL DR.

NOTE:
REFER TO STORM DRAINAGE PLAN (NORTH) -
SHEET C-2 FOR STORMWATER
MANAGEMENT FACILITY PLANTING PLAN

GENERAL PLANTING NOTES:

1. PLANT MATERIALS SHALL MEET MINIMUM REQUIREMENTS AS SET FORTH IN THE LATEST EDITION OF AMERICAN STANDARDS FOR HURSEY STOCK.
2. PLANTS SHALL BE HEALTHY, VIGOROUS SPECIMENS, FREE OF PESTS AND DISEASE.
3. PLANTS ARE SUBJECT TO THE APPROVAL OF THE LANDSCAPE ARCHITECT OR OWNER BEFORE, DURING AND AFTER INSTALLATION.
4. DO NOT ALLOW AIR POCKETS TO FORM WHEN BACKFILLING.
5. DO NOT BREAK ROOTBALL.
6. IMMEDIATELY SOAK NEW PLANTINGS WITH WATER.
7. STAKE TREES IMMEDIATELY AFTER PLANTING AS INDICATED IN DETAILS OR AS DIRECTED BY THE LANDSCAPE ARCHITECT.
8. CONTRACTOR IS FULLY RESPONSIBLE FOR MAINTENANCE INCLUDING WATERING, WEEDING, SETTLING, PRUNING OF THIS WORK UNTIL THE DATE OF SUBSTANTIAL COMPLETION.
9. THE CONTRACTOR IS ADVISED OF THE UNDERGROUND UTILITIES AND SHALL CHECK LOCATION OF SAME BEFORE COMMENCING DIGGING OPERATIONS.
10. CONTRACTOR SHALL FULLY GUARANTEE PLANTS FOR THIS JOB FOR A PERIOD OF ONE (1) YEAR BEGINNING ON THE DATE OF SUBSTANTIAL COMPLETION.
11. CONTRACTOR SHALL BE RESPONSIBLE FOR HIS/HER OWN TAKEOFF QUANTITIES AND REPORT ANY DISCREPANCIES TO THE LANDSCAPE ARCHITECT.
12. CONTRACTOR SHALL FLAG LOCATION OF PLANT MATERIAL FOR APPROVAL BY LANDSCAPE ARCHITECT BEFORE INSTALLATION.
13. PLANT BEDS SHALL BE MULCHED WITH A MINIMUM OF 3" OF CLEAN FRESH PINE STRAW.
14. AREAS DESIGNATED AS FLOWER BEDS SHALL RECEIVE 1/2" OF PLANTING MIXTURE TOPPED WITH 2" OF PINE BARK MULCH CHIPS.
15. PLANTING MIXTURE, 3 PARTS TOPSOIL, 1 PART COARSE SAND, ONE PART PEAT MOSS, OR APPROVED SUBSTITUTE.

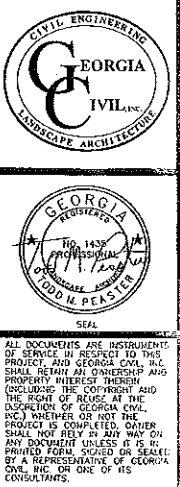

GEORGIA CIVIL, INC.
CIVIL ENGINEERING & LANDSCAPE ARCHITECTURE
216 N. MAIN ST. MADISON, GA 30650
PHONE: (706) 342-1104 FAX: (706) 342-1105

1st ASSEMBLY OF GOD ATHENS
1225 COLLEGE STATION ROAD
ATHENS, GA 30605
ATHENS-CLARKE COUNTY, GA
LLI-DIST. PARCEL

DATE: 1-12-07
PROJECT NO: 0041

NO.	DATE	DESCRIPTION
1	1/12/07	ACC COMMENTS
2	1/14/07	ACC COMMENTS
3	1/24/07	ACC COMMENTS
4	2/1/07	ACC RE-PERMIT
5		

TREE PROTECTION AND PLANTING PLAN

SHEET NO. **C9.1**

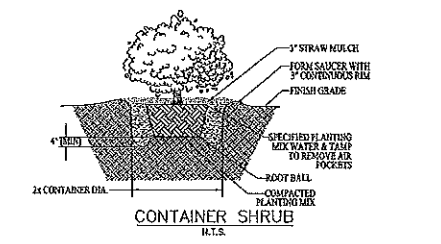
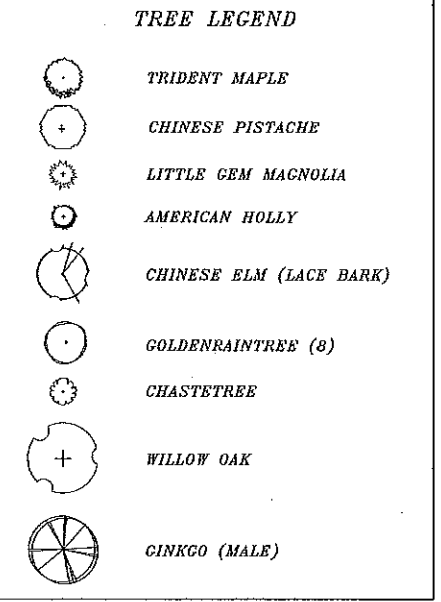
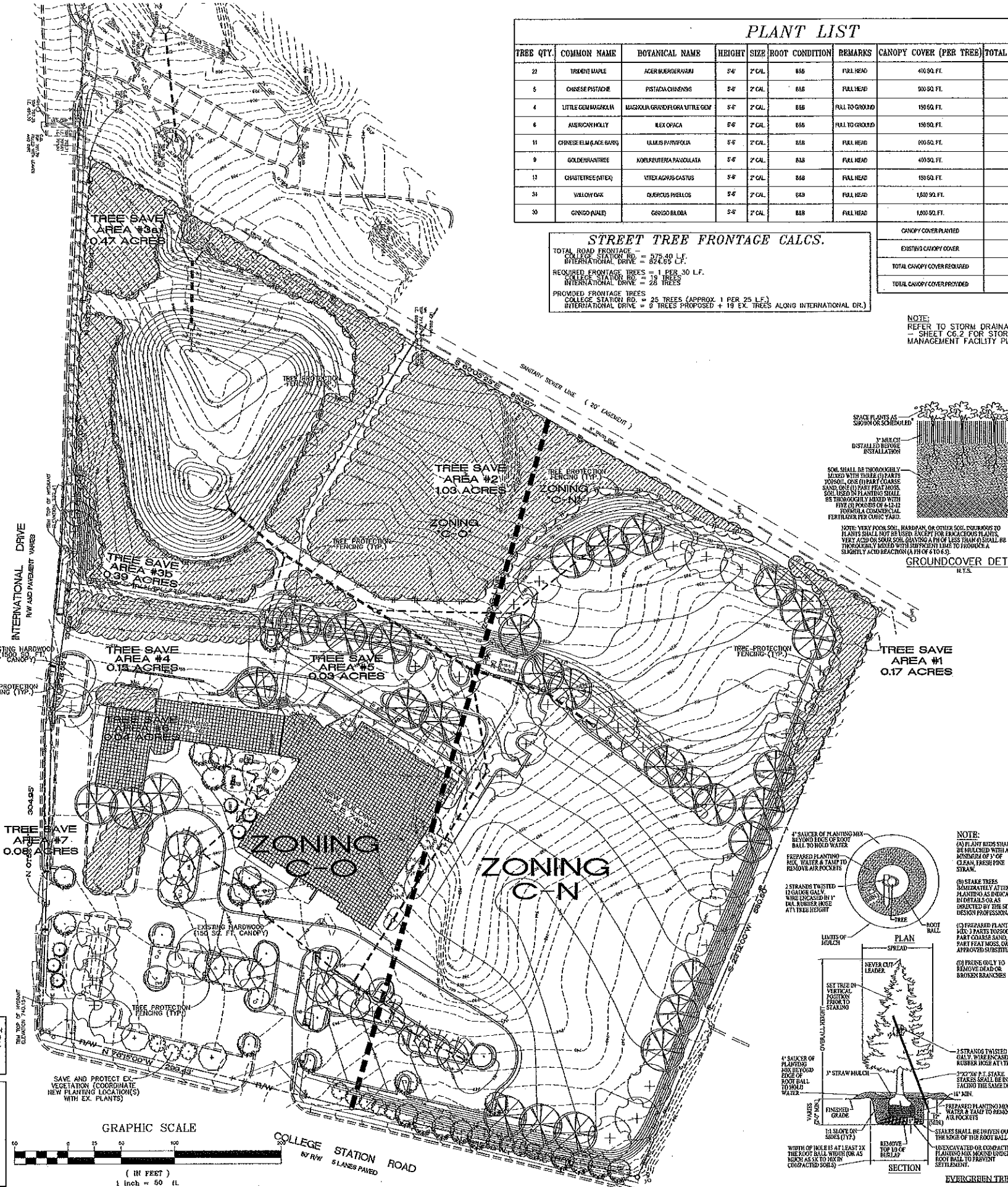

NOTE:
(1) REMOVE ALL PLASTIC, TWINE, ROPE AND WIRE, AND/OR BURLAP FROM TOP THIRD OF ROOT BALL PRIOR TO PLANTING. DO NOT BREAK ROOT BALL.
(2) SET TOP OF ROOT BALL FLUSH TO GRADE OR 1/2" HIGHER IN SLOWLY DRAINING SOILS. THE TRUNK FLARE SHALL BE VISIBLE AT THE TOP OF THE ROOT BALL. DO NOT COVER THE TOP OF THE ROOT BALL WITH SOIL.
(3) TAMP SOIL AROUND ROOT BALL BASE FIRMLY WITH FOOT PRESSURE SO THAT ROOT BALL DOES NOT SHIFT. DO NOT ALLOW AIR POCKETS TO FORM WHEN BACKFILLING. SOAK ROOT BALL AND FIT BANDAGE WITH WATER AFTER PLANTING.
(4) WIRE OR CABLE SIZES SHALL BE AS FOLLOWS: (1) TREES UP TO 2 1/2" CALIBER, 14 GAUGE, (2) TREES 2 1/2" AND GREATER, 12 GAUGE.
(5) TWINE OR CABLE ONLY ENOUGH TO KEEP FROM SLIPPING. ALLOW FOR SOME TRUNK MOVEMENT. PLASTIC HOSE SHALL BE LONG ENOUGH TO ACCOMMODATE 1/2" OF GROWTH AND SUPPORT TREE FROM THE WIRE. TUCK ANY LOOSE ENDS OF THE WIRE OR CABLE INTO THE WIRE WRAP SO THAT NO TRAP WIRE ENDS ARE EXPOSED AFTER BACKFILLING.
(6) BREATHABLE FABRIC TREE WRAP SHALL BE INSTALLED AT TIME OF PLANTING AND BE REMOVED NO LATER THAN 12 MONTHS AFTER PLANTING.
(7) BREATHABLE FABRIC TREE WRAP APPLIED FROM TRUNK FLARE TO FIRST BRANCH. WRAP PAPER FROM THE BOTTOM UP WITH SUFFICIENT OVERLAP TO COVER ALL BARK.
(8) TWO-WALLED PLASTIC SHEETING OR TREE SHELTER MATERIAL (USED IN PLACE OF BREATHABLE FABRIC TREE WRAP) SHALL BE APPLIED FROM TRUNK FLARE TO FIRST BRANCH. APPLY THE PLASTIC SHEETING TIGHTLY AROUND THE TRUNK TO LEAVE A 1/4" GAP BETWEEN THE TRUNK AND THE SHEETING. SECURE PLASTIC SHEETING AS RECOMMENDED BY MANUFACTURER.
(9) ASSURE THAT THE BEARING SURFACE OF THE PROTECTIVE COVERING OF THE WIRE OR CABLE AGAINST THE TREE TRUNK IS A MINIMUM OF 1".
(10) REMOVE ALL STAKING AS SOON AS THE TREE HAS GROWN SUFFICIENT ROOTS. STAKES SHALL BE REMOVED NO LATER THAN THE END OF THE FIRST GROWING SEASON AFTER PLANTING.

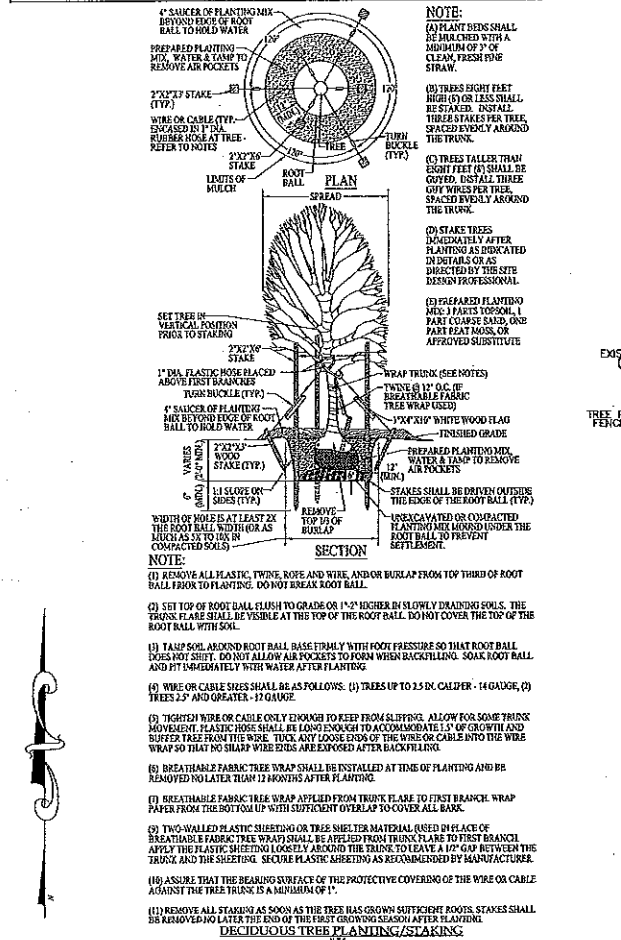

24-HOUR CONTACT
ROGER BURGESS
(706) 548-3409

UTILITIES PROTECTION CENTER
CALL FREE
IN METRO ATLANTA
(770) 632-4344
THROUGHOUT GEORGIA
1-800-282-7411
THREE WORKING DAYS BEFORE YOU DIG

DO NOT DUPLICATE DRAWINGS WITHOUT PERMISSION

